

## TECHNICAL DATA - MARINE

### Undercounter drawer

The range of marine neutral furniture includes various types of tables, cabinets, shelves, trolleys and racks. Thanks to the flexible modular construction they are easy to combine to create customised solutions that meets all requirements. All units are made of stainless steel and comply with the hygiene and other standards for professional kitchens.



#### GENERAL

- Easy to clean stainless steel construction
- Two and three drawer options
- Marine locking latch with a key lock
- Special executions and sizes available on request
- Wide range of accessories

#### TECHNICAL FEATURES

- Double body and doors s/s t=0,80mm
- Long extension sliding rails
- Welded construction
- Adjustable legs with bolt holes
- S/s brush exterior

# Undercounter drawer D2

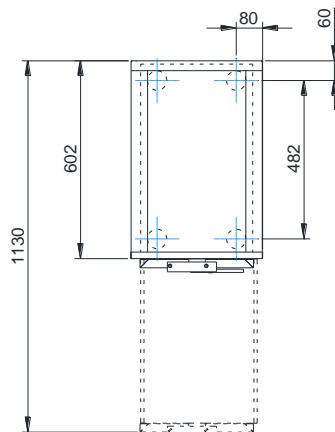
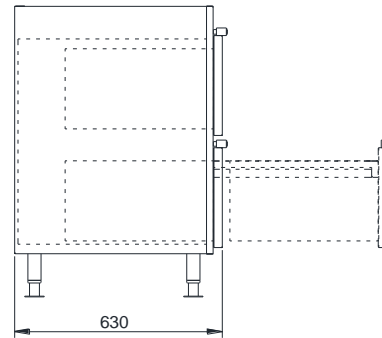
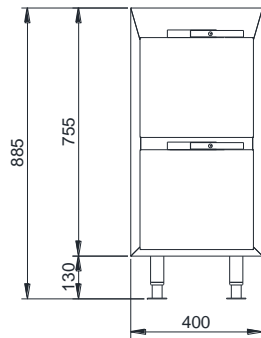

Det. of marine leg

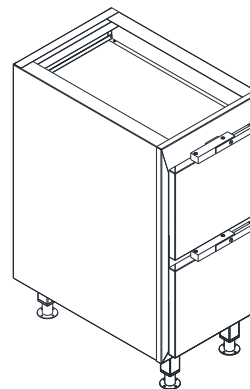
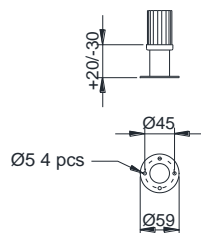

TECHNICAL DATA		
Model	N-028-D2-4x6,3	N-028-D2-5x6,3
External dimensions w x d x h mm	400x630x885	500x630x885
Net weight kg	36	41
Internal volume (load volume) dm <sup>3</sup>	65	87
Unit volume m <sup>3</sup>	0,32	0,39
Unit dimensions mm		
height		
depth	1035	1035
width	680	680
	450	550

Due to continuous product development we reserve the right to technical changes without notice.

# Undercounter drawer D3

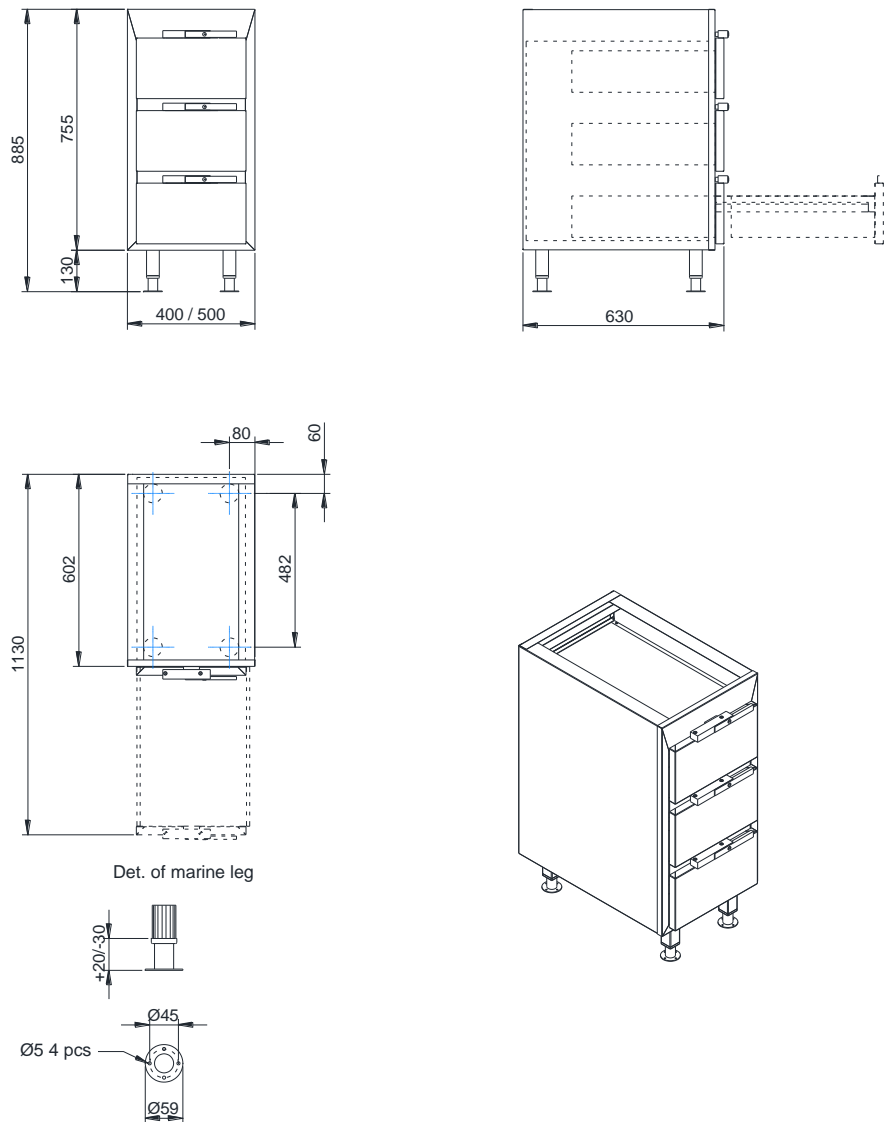

TECHNICAL DATA		
Model	N-028-D3-4x6,3	N-028-D3-5x6,3
External dimensions w x d x h mm	400x630x885	500x630x885
Net weight kg	41	47
Internal volume (load volume) dm <sup>3</sup>	54	72
Unit volume m <sup>3</sup>	0,32	0,39
Unit dimensions mm		
height		
depth	1035	1035
width	680	680
	450	550

Due to continuous product development we reserve the right to technical changes without notice.

